

What You Will Need

- Base Plate Assembly Repair Kit
- Impact Driver
- 7/16" Socket
- 5/32" Allen Wrench
- 1/2" Socket
- 3/16" Allen Wrench

Base Plate Assembly Replacement Kit

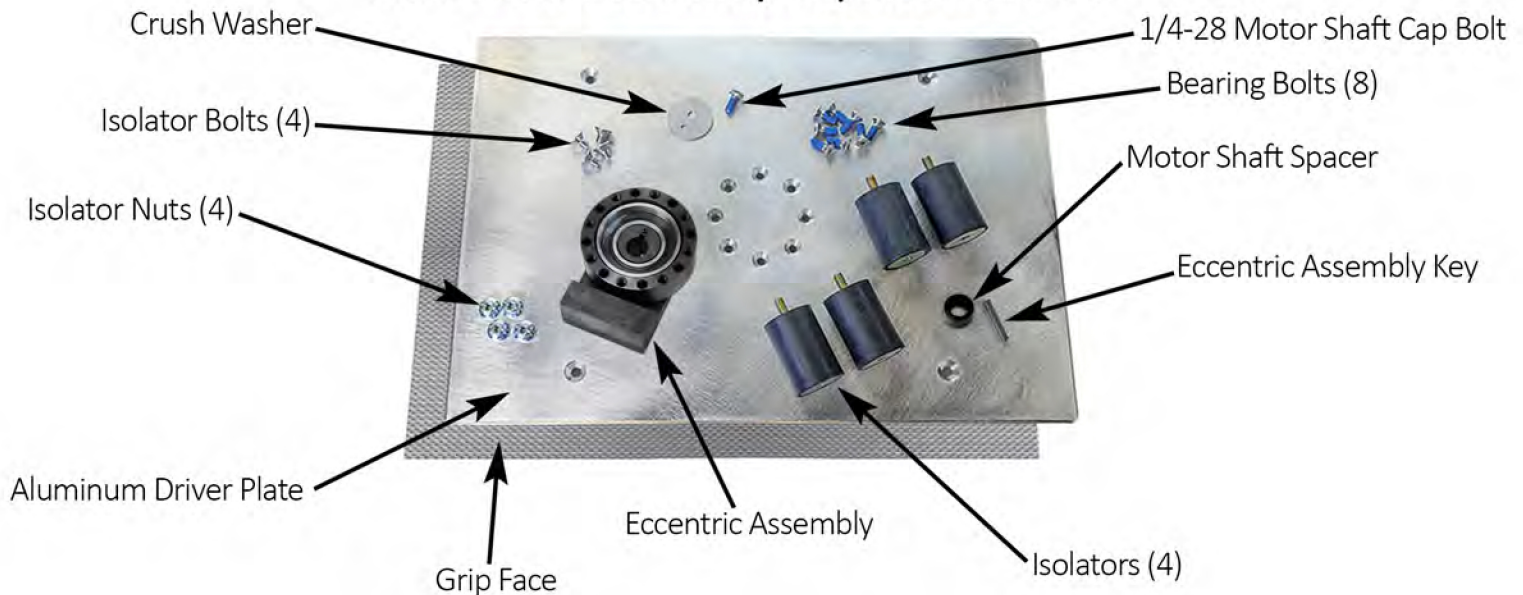

Note: 28" kits will include 4 additional isolators, & bolts.

1. Remove machine weights. Using a 1/2" socket remove the four isolator nuts.



2. Lay the machine back and remove the pad.

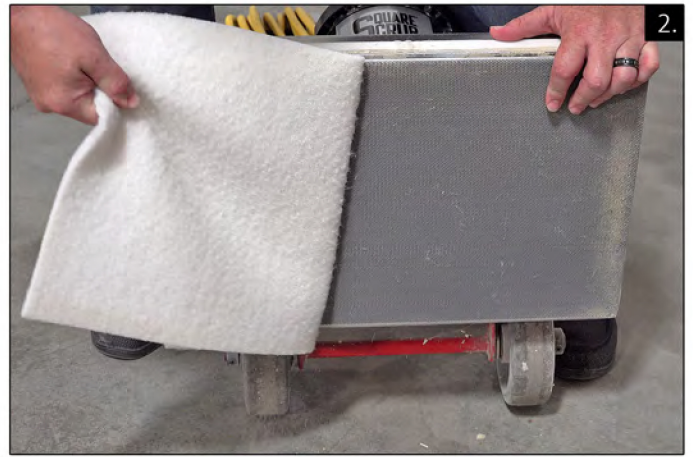

3. Remove the grip face from the plate.



4. Place plate face down on a Xylene soaked towel for 30 min.



5. After soaking in Xylene, scrape any remaining glue from the plate.



800-557-6822
www.squarescrub.com

6. Using a 5/32" allen wrench, remove the 8 bearing bolts.

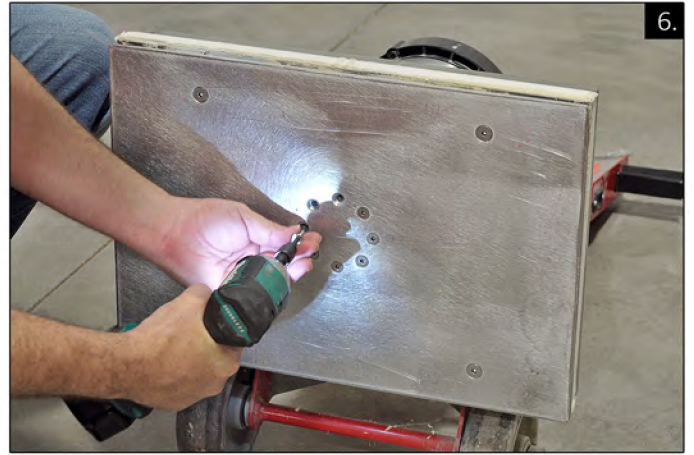

7. Remove the aluminum plate.
Clean debris or build-up if needed.

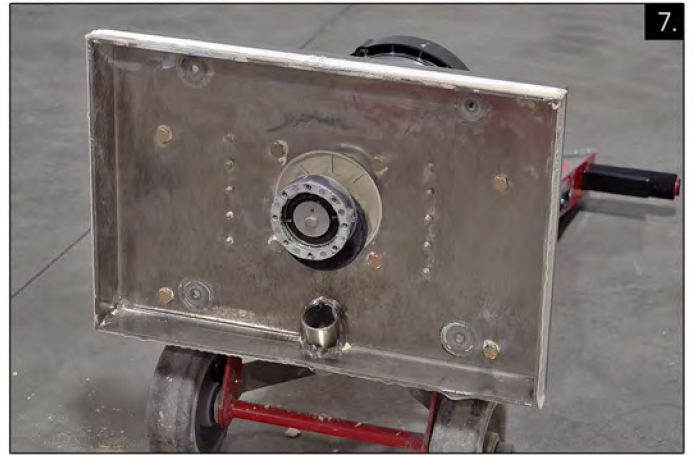

8. Using a 7/16" socket, remove the cap bolt from the motor shaft.



9. Remove the crush washer from the bearing.



10. Remove bearing from the motor shaft. May require a two-jawed pulley puller. Clean debris or build-up if needed.



11. Remove the motor shaft spacer.



12. Replace the old spacer with the new spacer included in the eccentric assembly repair kit. Apply silicone on top & bottom of spacer. Do not reuse old motor shaft spacer.



13. Apply a thin layer of anti-seize to the motor shaft.



14. Install the new eccentric assembly onto the motor shaft. Line up key notches on the motor shaft and bearing to insert key.

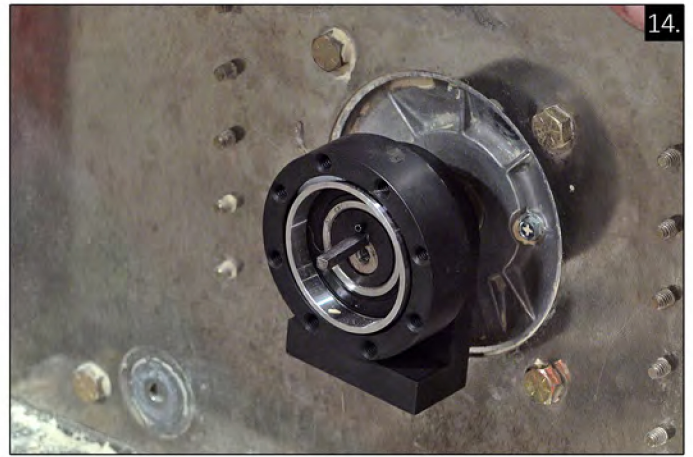

15. Install new motor shaft crush washer and 1/4-28 cap bolt.



16. Run a bead of 100% silicone on the surface of the bearing cup.



17. Install Isolators. Thread the isolator bolts through the bottom of the driver plate. Apply a small amount of the included Loctite onto the isolator bolt. While holding the isolator, tighten with a 3/16 allen wrench. (The 28" kit will include 4 additional isolators and bolts.)



18. Install aluminum driver plate.
Using a small screwdriver, align the aluminum plate holes with bolt holes on the eccentric assembly. Tighten the 8 bearing bolts.

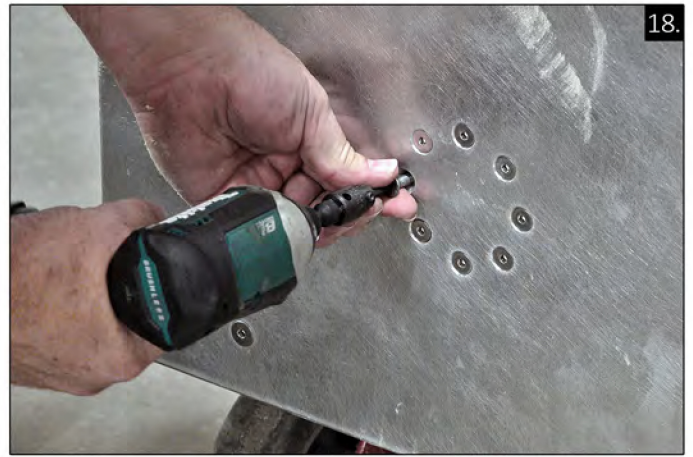

19. Set machine upright onto a driver pad, and tighten isolator nuts.



20. With weights on and sitting on a driver pad, ensure machine is functioning properly.



21. Install a new gripface.
Abrade the plate using an orbital sander with 80 grit sandpaper to remove a very thin layer of aluminum evenly.



22. Clean the aluminum with 91 % alcohol and a lint free cloth. Let the plate dry for at least 5 min.



23. Remove back liner of the new grip face 2" from the long edge.

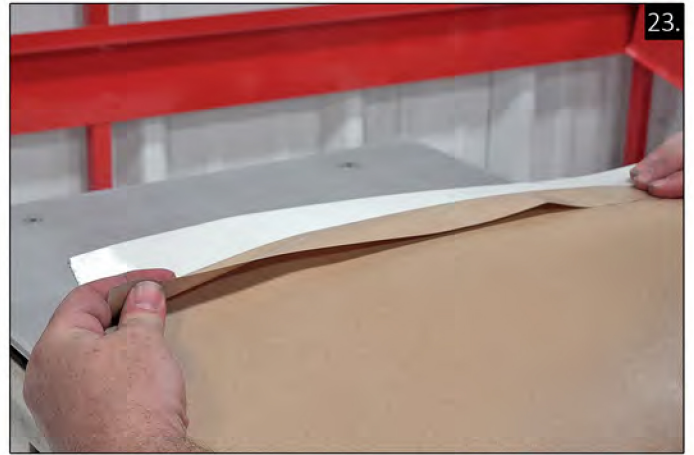

24. Evenly, line up the exposed area against the long edge of the plate.

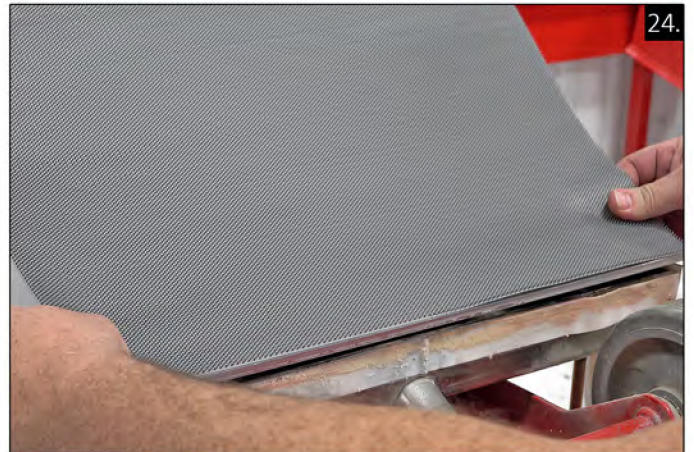

25. Smooth evenly, while slowly pulling the liner until completely removed and press firmly around all areas of the grip face.

Set machine upright on a driver pad for 24 hrs with machine weights before using.

